

MA-Series Inline Bluetooth® & USB Adapters



Product Description

The MA-Series Inline Adapters are uniquely designed accessories which enable Pyxis Lab inline sensors to be accessed, viewed, configured and calibrated via the uPyxis APP for Mobile or Desktop devices. The MA-Series adapters are offered in a Bluetooth 5.0 wireless platform in 5-Pin, 7-Pin and 8-Pin formats enabling connectivity to any of the sensor designs offered by Pyxis Lab. Additionally, the new design incorporates a USB-C adapter port for those desiring a direct wired connection and power supply to a Pyxis probe using the uPyxis Desktop APP and portable PC or Smart device with USB-C port.

MA-NEB for PC Bluetooth® Capability

For those desiring to use the uPyxis Desktop App in Bluetooth/ wireless mode, the Pyxis MA-NEB is a USB adapter specifically designed to be inserted into the user's PC or Laptop device. This small adapter enables the user's PC to communicate via Bluetooth 5.0 directly with any Pyxis MA Series Bluetooth Adapter (MA-WB, MA-WA and MA-CR). NOTE- For PC's containing Windows 10.0 or more recent, the MA-NEB is not needed as uPyxis Desktop can connect directly to the Pyxis sensor MA-series adapter via the PC's internal Bluetooth chip. The MA-NEB can be used with uPyxis Desktop APP if desired. The uPyxis Desktop App may be downloaded per link attached.



MA-NEB USB Adapter

Rapid Installation & Connection

The MA-Series Inline adapters are designed to be installed easily and without the need for tools. Each format is rapidly connected with "quick-adapters" designed for its sensor conductor pin format (5, 7 & 8). When installed, the MA-Series Inline Adapters utilize the power provided (24VDC) from the controller it is connected to, passing that power supply through to the connected Pyxis inline sensor. The new MA-WB and MA-CR design also offer USB-C ports for power supply and uPyxis wired connection to any 7-pin or 8-pin Pyxis sensor from laptop or mobile PC while using uPyxis Desktop. Additionally, each MA-Series inline adapter offers 4-20mA and/or RS485 Modbus connectivity from the Pyxis sensor to the receiving controller.

Contact Us at order@pyxis-lab.com for More Information...

Connecting to a Smartphone

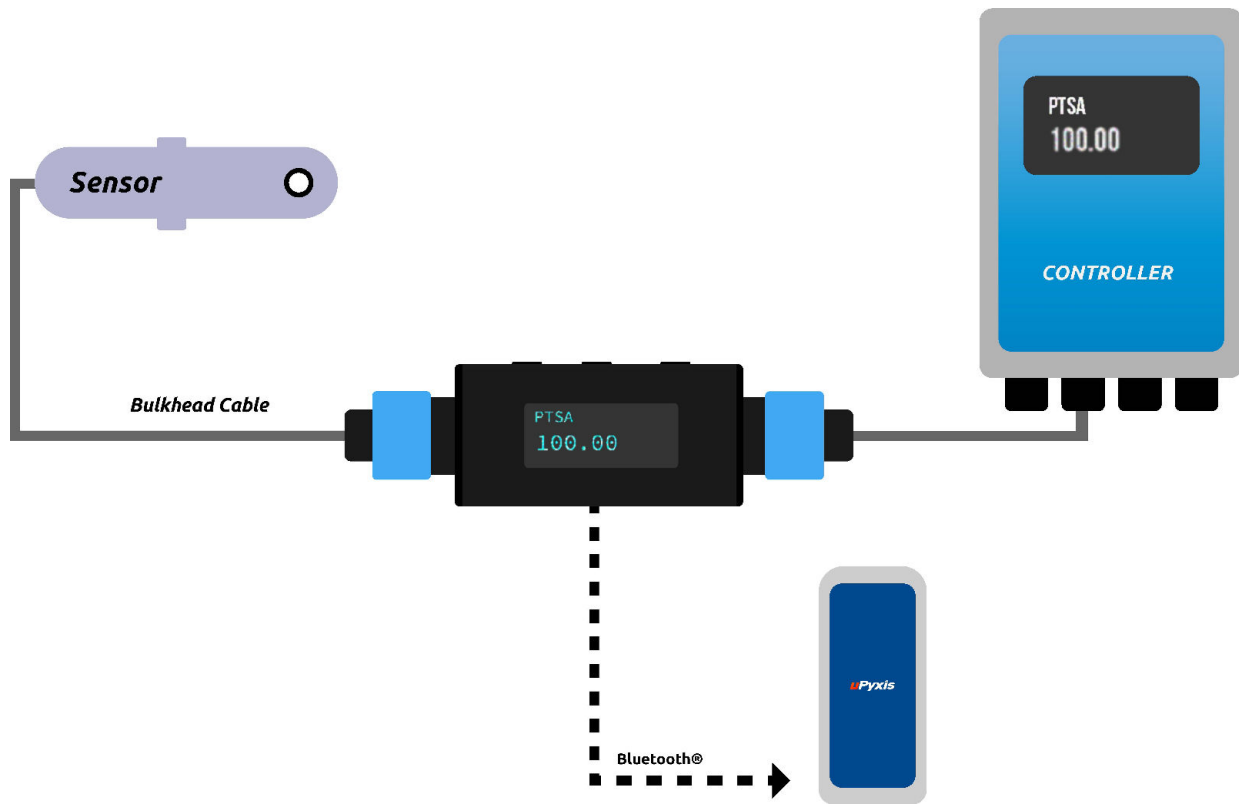

Connecting to a Desktop via Bluetooth®

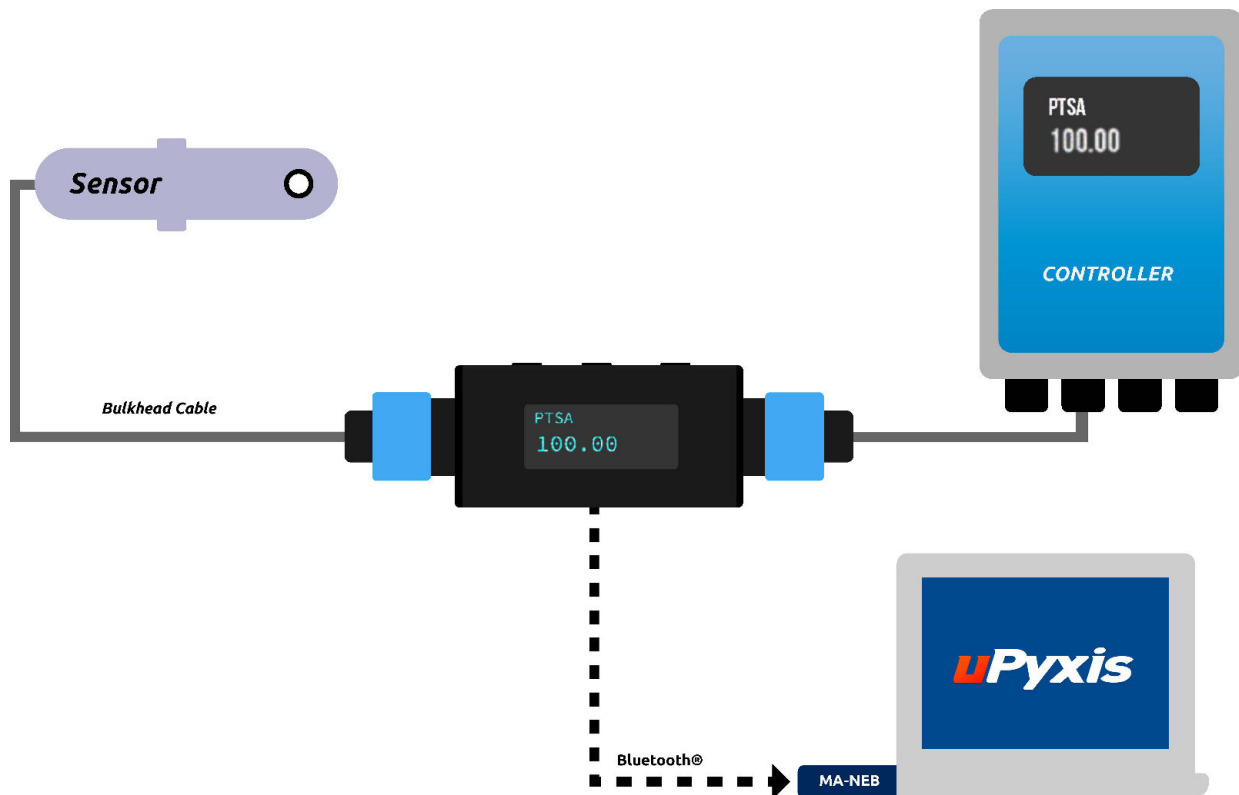

Connecting to a Desktop via USB-C

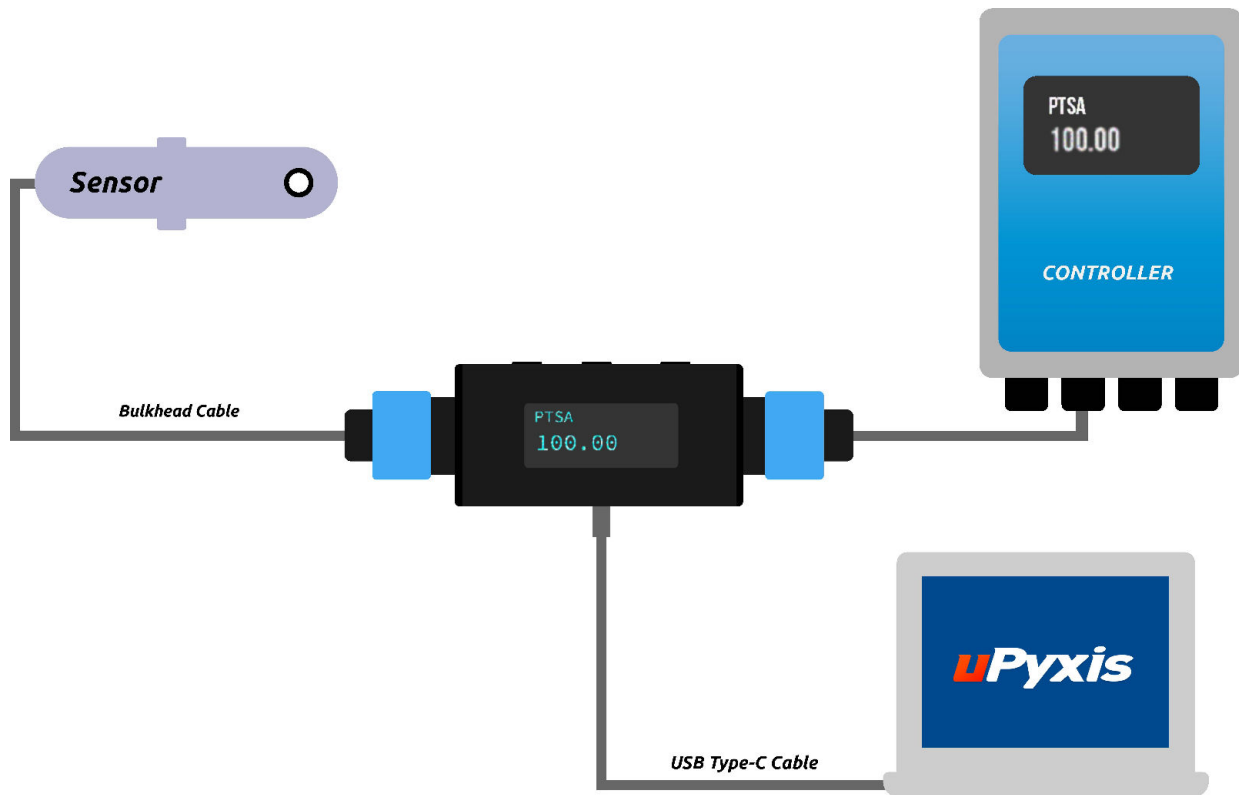

Item	MA-WA	MA-WB	MA-CR	MA-485	MA-NEB
P/N	MA-WA	MA-WB	MA-CR	MA-485	MA-NEB
Power Input	24V DC @10mA from Controller				USB
Adapter Pin Format	5-Pin	7-Pin	8-Pin	7-Pin	USB
Signal Output	RS-485 via BT	RS-485 via BT & USB-C		USB-A to PC	
Signal Passthrough	RS-485	(2) 4-20mA + RS-485		(2) 4-20mA + RS-485	N/A
Enclosure Material	ABS				
Enclosure Rating	IP54 Rating				
Local Display	No	Yes		No	
Storage Temp.	20–140 °F (-7–60 °C)				
Operational Temp.	40–122 °F (4–50 °C)				
Dimension	3.5in (90mm) L x 2.4in (60mm) x 1.6in (40mm) H				2in L x .5in W
Weight	.10lbs (45g)				5g
Certificates	CE, RoHS, UKCA				N/A

Contact Us at order@pyxis-lab.com for More Information...